



Applies to: All Strength



VERIFIED PROBLEM AREA

Red Knobs Falling Off of Pull Pins on Strength



ROOT CAUSES

Our investigation determined the male to female threads would become loose over time from the shock load of the spring rebound.



SOLUTION

Our engineering team changed the design of the Pull Pin Knob which now incorporates a new fastening feature. The new Pull Pin Knob is secured by a lock nut threaded directly on to the pin shaft itself. Now the knob is completely held captive to prevent it from ever coming off. We have placed a cap above the locknut to make the new version easily identifiable to any customer or user. This is 100% backwards compatible across all applications, making it easy to upgrade ROM pins on an entire machine and/or in an entire club.



Fig. 1

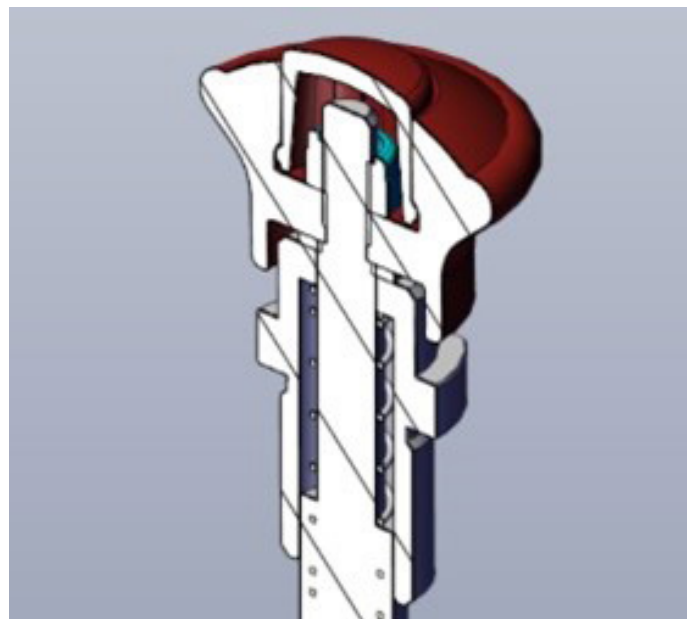

Fig. 2